

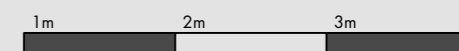

tosters  
am platz

TOP A21  
4-Zimmer-Wohnung  
Dachgeschoss 110.35m<sup>2</sup>

Wohnküche	46.92 m <sup>2</sup>
Schlafen 1	12.83 m <sup>2</sup>
Schlafen 2	14.63 m <sup>2</sup>
Kind	13.89 m <sup>2</sup>
Bad	4.87 m <sup>2</sup>
WC/DU	4.14 m <sup>2</sup>
Abstellraum	3.02 m <sup>2</sup>
Vorraum	2.89 m <sup>2</sup>
Garderobe	7.16 m <sup>2</sup>
<hr/>	
Wohnnutzfläche	110.35 m <sup>2</sup>
Terrasse	22.37 m <sup>2</sup>
Kellerabteil	6.19 m <sup>2</sup>

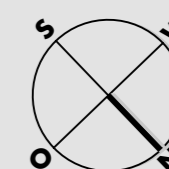
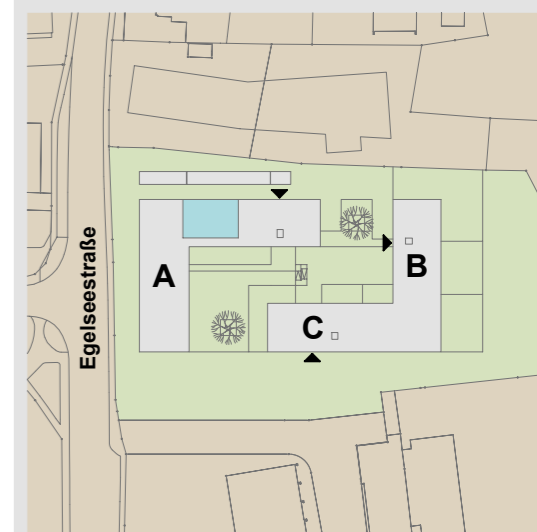

Maßstab 1:50 (1cm = 50cm)



17.07.2017