

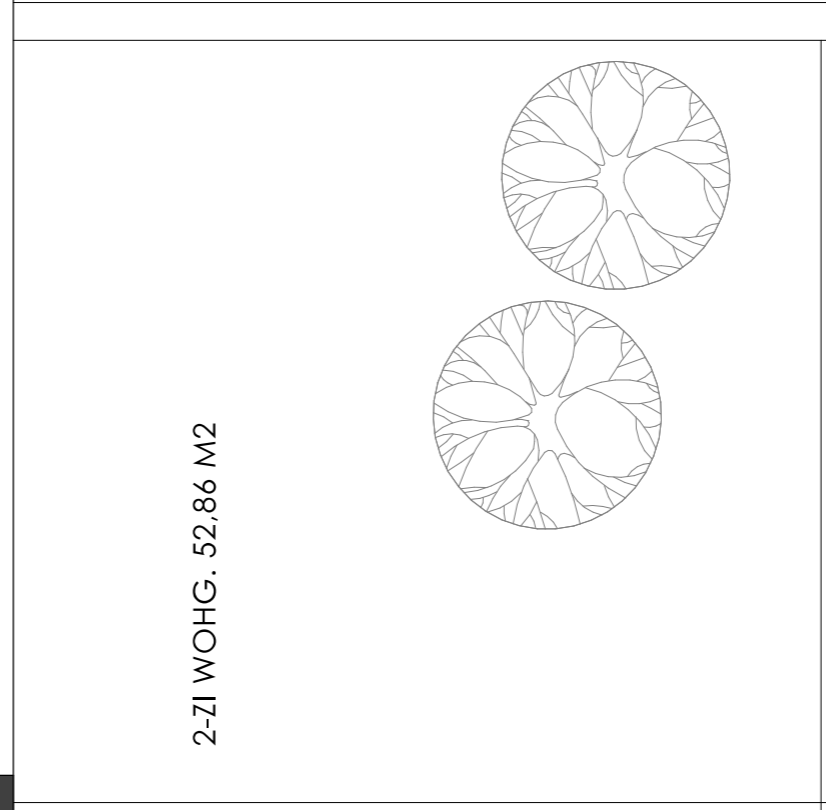

3-ZI WOHG.80,75 M2

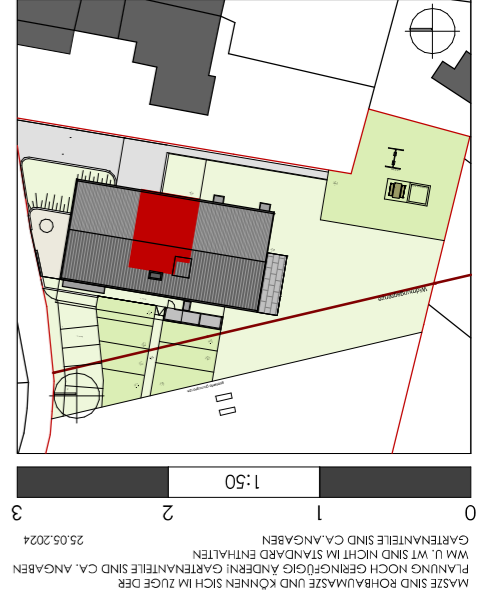

2-ZI WOHG. 52,86 M2



MFH WALGAUBLICK GÖFIS

BADRUS

A-6811 GOEFIS

TOP 05 OG MITTE 2 ZI

WOHNUNG	52,86 M2
BALKON	17,02 M2
KELLER	7,87 M2
GARTEN	21,46 M2

ZIMCON IMMOBILIEN GMBH.
 MSC KARL ZIMMERMANN
 KIRCHSTRASSE 2 | A-6811 GÖFIS
 T: +43 699 107 470 55 - INFO@ZIMCON.AT

